

VEDERE IN PLAN

SCARA 1:20

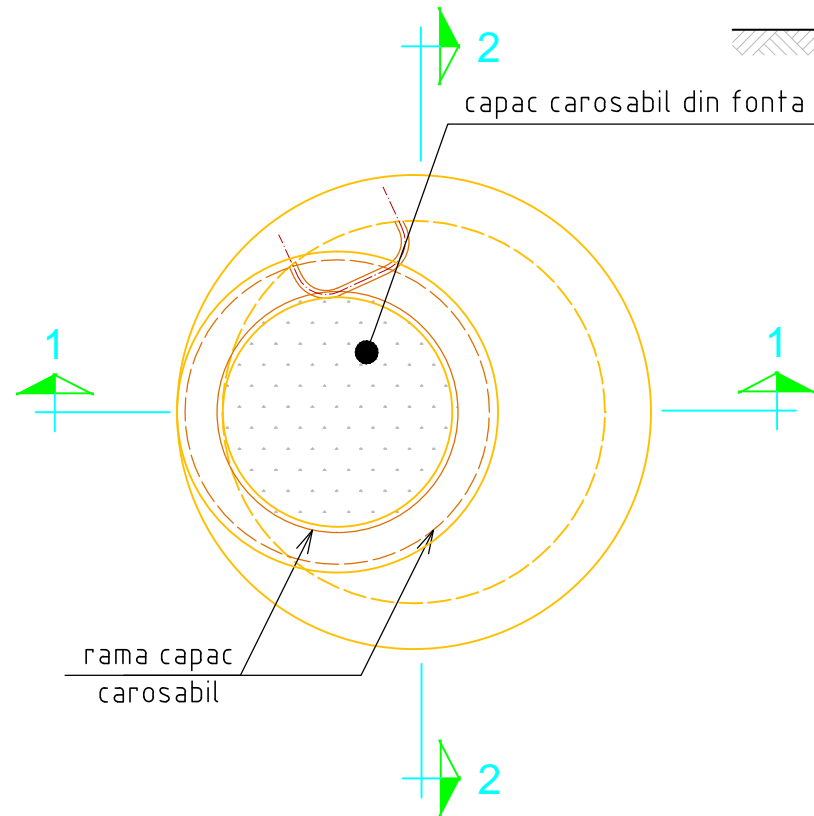

SECTIUNEA 3-3

SCARA 1:20

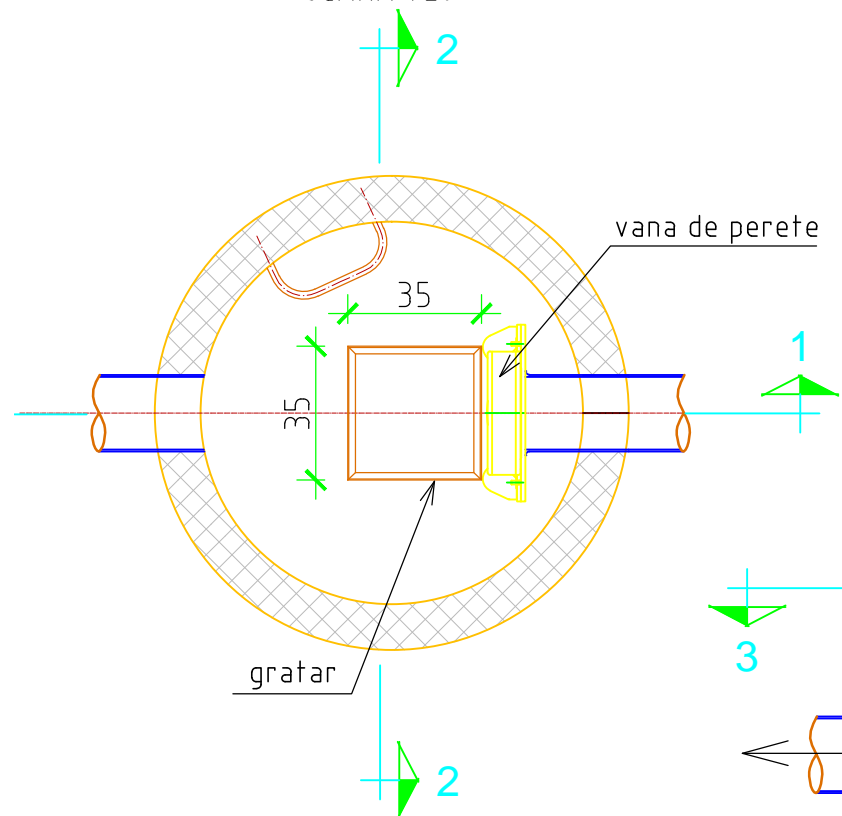

SECTIUNEA 1-1

SCARA 1:20

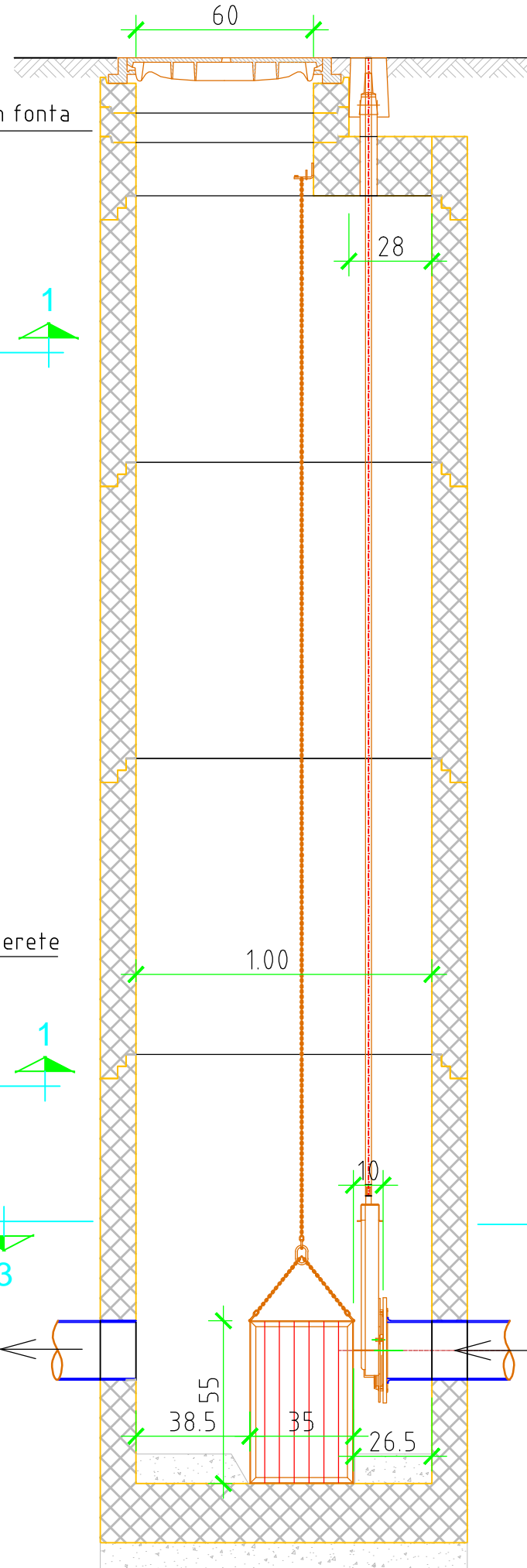

SECTIUNEA 2-2

SCARA 1:20

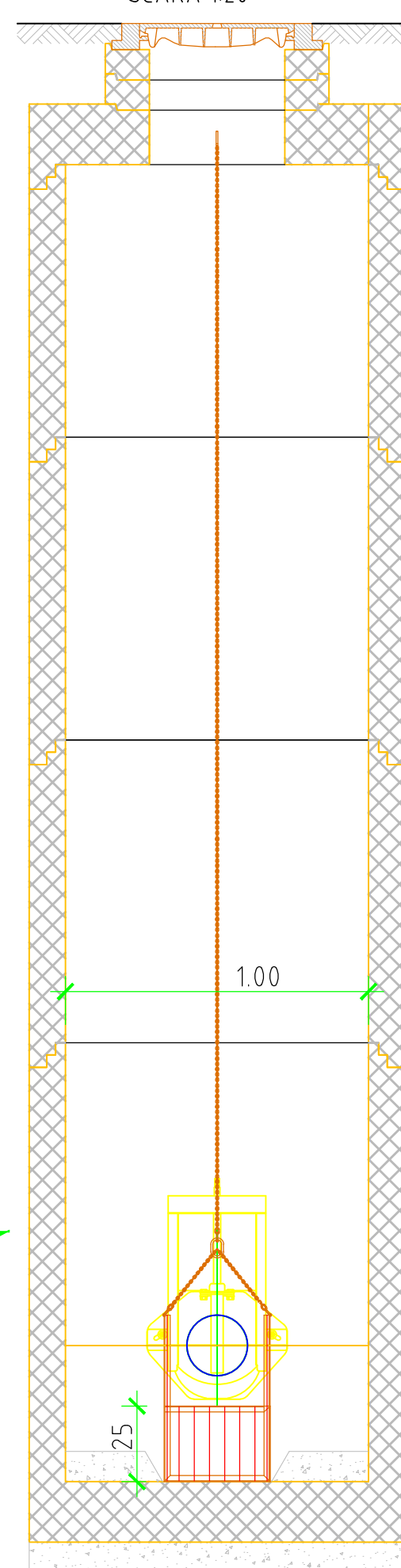

Denumire SPAU	Denumire camin	Diametru conducta	Cota radier conducta intrare
SPAU 1	CD11	250 mm	228.80
SPAU 2	CD2	250 mm	257.84
SPAU 3	CD5	250 mm	196.18
	CD6	250 mm	196.16
SPAU 4	CD3	250 mm	193.31
	CD4	250 mm	193.24
SPAU 5	CD1	250 mm	262.57
SPAU 6	CD14	250 mm	218.90
SPAU 7	CD8	250 mm	235.34
	CD9	250 mm	238.54
	CD10	250 mm	234.39
SPAU 8	CD15	250 mm	193.35
SPAU 9	CD12	250 mm	233.55
	CD13	250 mm	232.77
	CD14	250 mm	234.32

Rev	Nume	Ver	Aprb	Data	Descriere

Autoritatea contractanta: **S.C.AQUACARAS S.A. CARAS SEVERIN**

Adresa: P-ta Republicii, nr. 7, Resita
Jud. Caras Severin
Tel.: +40 255 212 458
Fax.: +40 255 214 421
E-mail: office@aquacaras.ro

Proiectant:

**Consortiu S.C Eptisa Romania
S.R.L. si Eptisa Servicios de Ingenieria S.L.**
Sos. Dudesti-Pantelimon nr. 42, RAMS center, et. 5, corp A,
sector 3, Bucuresti
Tel: +40 21 301 14 70
Fax: +40 21 301 14 80
www.eptisa.com



Proiect:

**MODERNIZAREA INFRASTRUCTURII DE
APA SI APA UZATA IN JUDETUL
CARAS SEVERIN - AGLOMERAREA RESITA**

Plansa:

**Detaliu tip
Camin canalizare menajera
cu gratar tip cos**

Desenat: Ing. B. Paraschiv	Data: Aprilie 2013
Verificat: Ing. M. Serbanoiu	Data: Aprilie 2013
Aprobat: Ing. D. Spiridon	Data: Aprilie 2013

Plansa nr.	Revizia
------------	---------

CS-RE-PT/DA-C-C-05**0**

Scara plansa: 1:20